

CBRE

TENANT
Name

Tenant
NAME

4100

WASHINGTON ROAD | McMURRAY

3,600 SF RETAIL SPACE | COMING SOON IN 2024 | DRIVE-THRU AVAILABLE

HIGHLIGHTS



Building Size
3,600 SF



Parking Spaces
18 • Drive-Thru Available

THE NEIGHBORHOOD

4100 Washington Road is located in Peters Township, an area known for its strong demographics, including household income, population, housing values, and exceptional school districts.

TRAFFIC GENERATORS

- Donaldson's Crossroads
1 min. / 0.4 mile
- South Hills Village Mall
11 min. / 6 miles
- Southpointe Business Park
8 min. / 2.9 miles
- The Meadows Racetrack & Casino
13 min. / 7 miles
- Downtown Pittsburgh
29 min. / 23 miles

4100

WASHINGTON ROAD (RT. 19) | McMURRAY, PA 15317

FLOOR PLAN

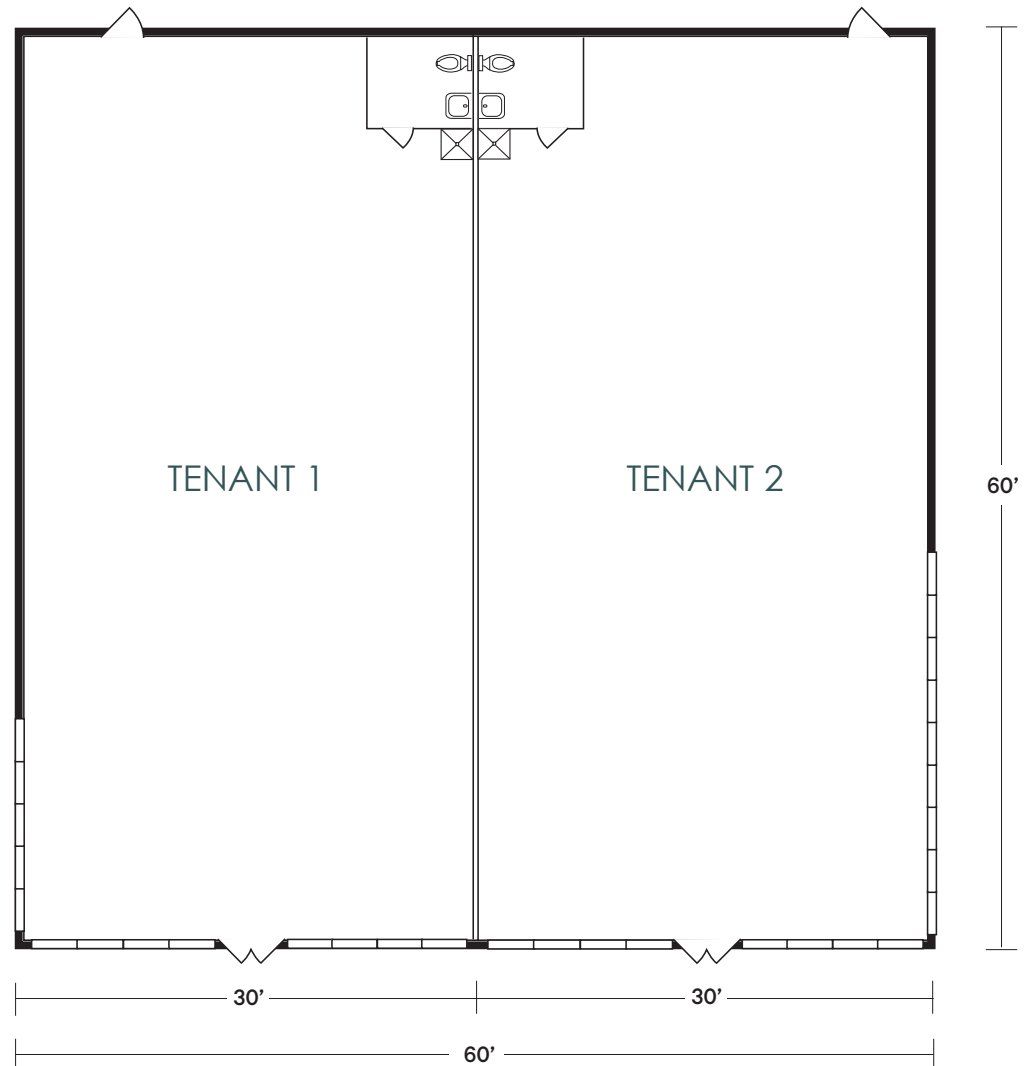



DEMOGRAPHICS

1 Mile

\$165,125
 Average Household Income

4,577
 Population



49.3
 Current Median Age

1,764
 Households

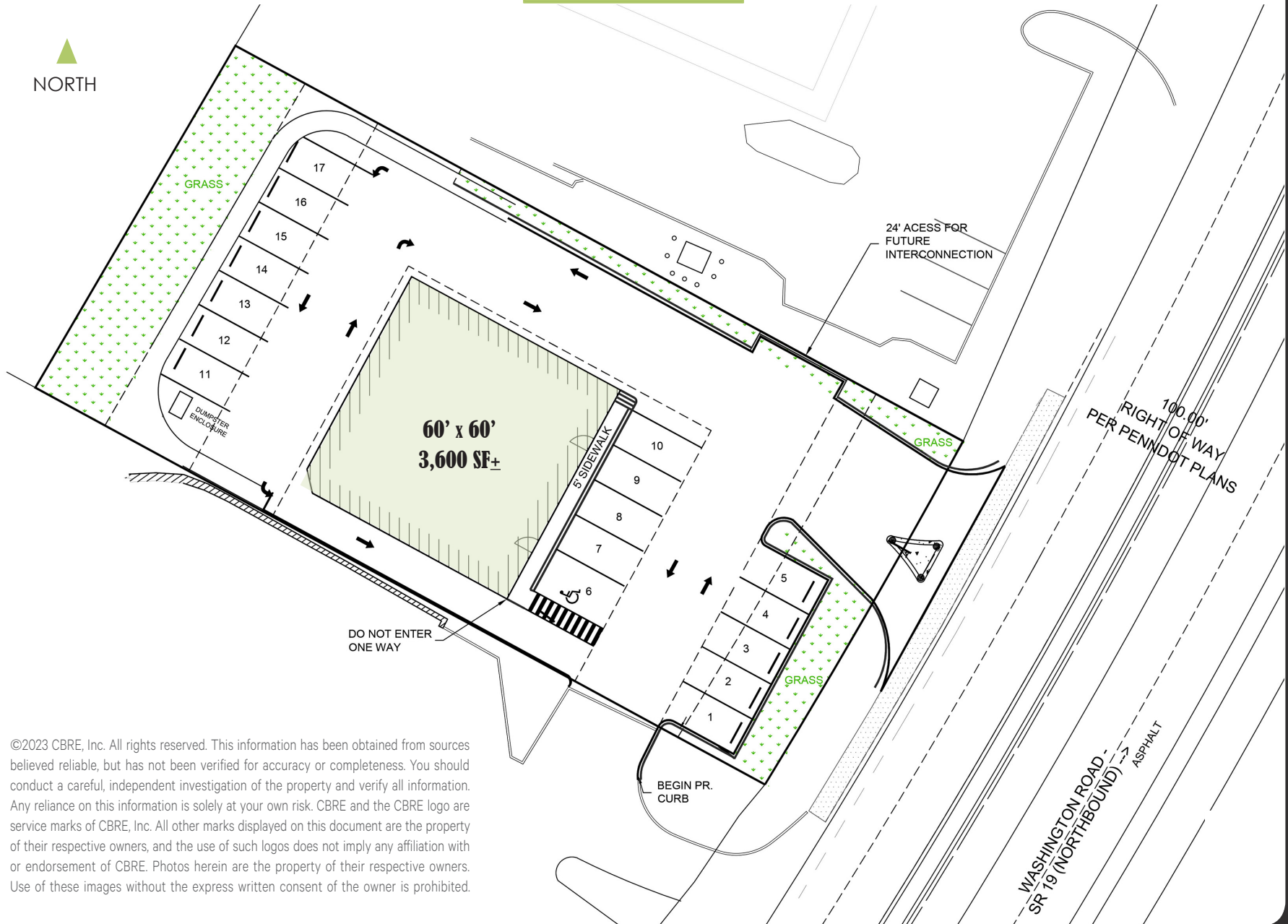

\$365,200
 Average Home Value

27,481
 Traffic Count
 (at Crosswinds Drive)

SITE PLAN

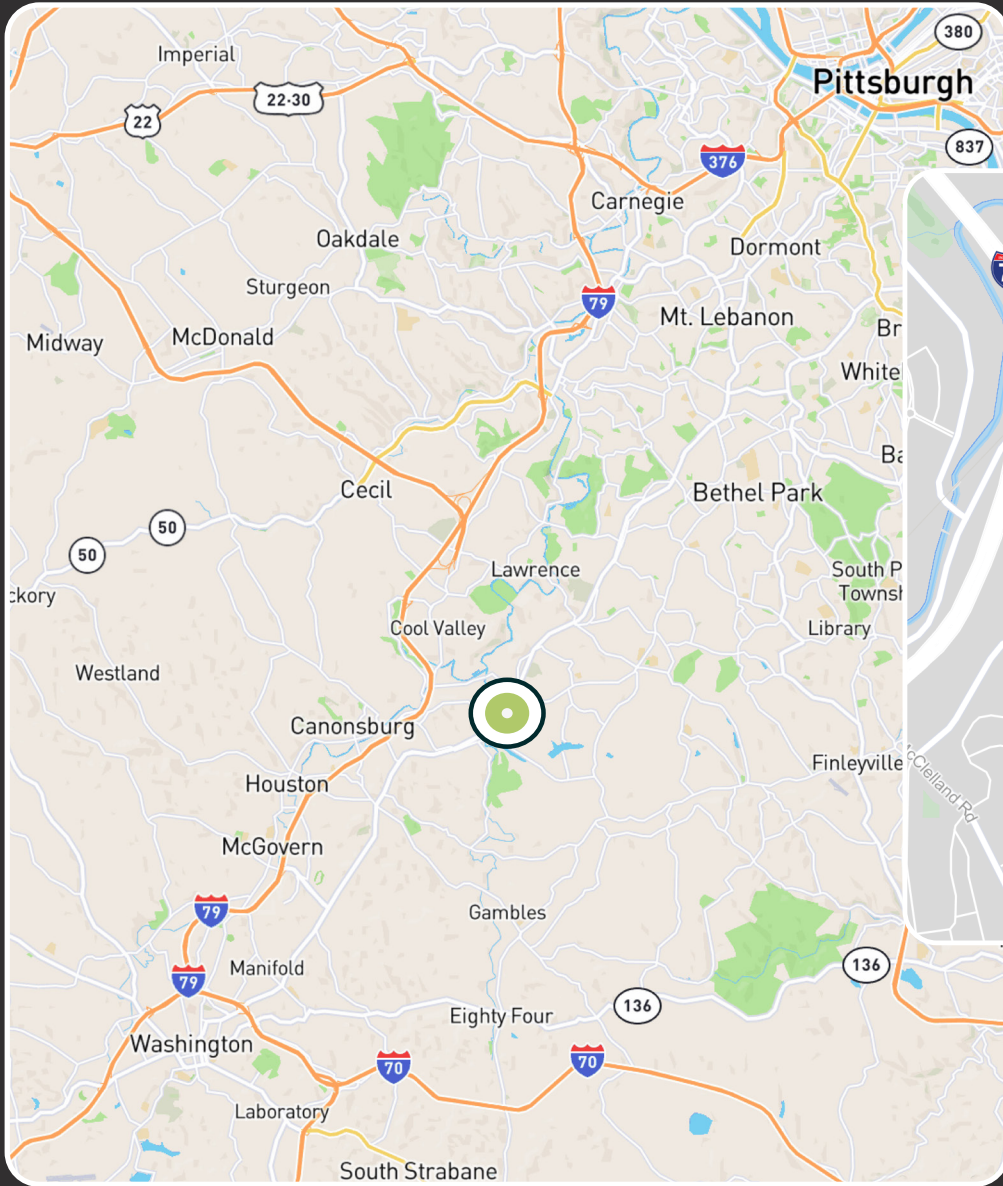

©2023 CBRE, Inc. All rights reserved. This information has been obtained from sources believed reliable, but has not been verified for accuracy or completeness. You should conduct a careful, independent investigation of the property and verify all information. Any reliance on this information is solely at your own risk. CBRE and the CBRE logo are service marks of CBRE, Inc. All other marks displayed on this document are the property of their respective owners, and the use of such logos does not imply any affiliation with or endorsement of CBRE. Photos herein are the property of their respective owners. Use of these images without the express written consent of the owner is prohibited.



LOCATION

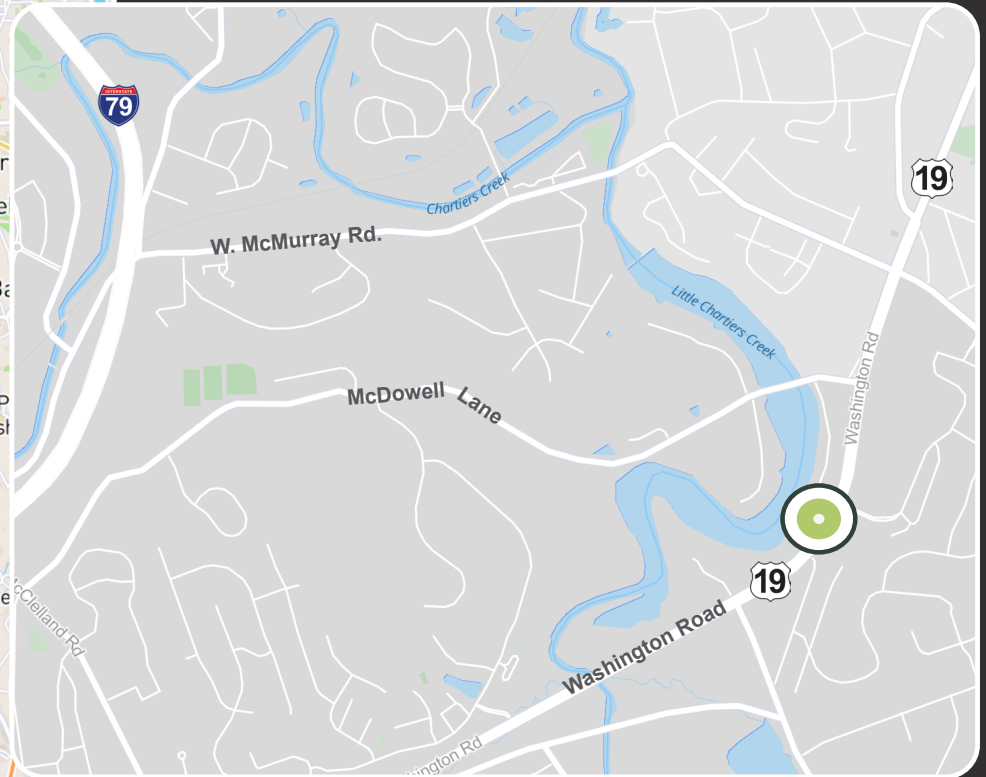

- 7 min. / 2.7 miles from Southpointe
- 17 min. / 7.9 miles from Bridgeville
- 20 min. / 10 miles from Washington
- 30 min. / 25.7 miles from the Pittsburgh International Airport
- 37 min. / 22.8 miles from downtown Pittsburgh

CBRE

One Oxford Centre | 301 Grant Street, Suite 4000
Pittsburgh, PA 15219 | www.cbre.com

KIM CLACKSON

Executive Vice President
412 471 3018
kim.clackson@cbre.com

MATT CLACKSON

Senior Vice President
412 471 4069
matt.clackson@cbre.com

NICOLE CLACKSON-ROSSMAN

Senior Associate
412 471 3385
nicole.clackson@cbre.com